



JIRA API Integration

[Mail: Contact@kloudspot.com](mailto:Contact@kloudspot.com)

www.kloudspot.com

Follow us on



Contents

Jira API Integration.....	3
To add JIRA in integrated Apps.	6

Jira API Integration

1. It enables you to receive notifications in the **'Kloudspot Hybrid Work'** app when something changes in the JIRA application in relation to the project.
2. To integrate Jira into the **'Kloudspot Hybrid Work'**, an application token is required.
3. To add it, navigate to the **Advanced Settings** page, then to **Configuration -> Hybrid Settings > Application Integrations** then scroll down and find the **JIRA API Access**.

JIRA API Access		
Base URI	User ID	Application Token
<input type="text" value="https://kloudspot.atlassian.net"/>	<input type="text" value="@kloudspot.com"/>	<input type="text" value="Content Hidden"/>

4. To obtain the Application Token, follow the instructions.
5. Log in to the ATlassian account with company credentials. To go to the log-in page, click the link below.

Note: The token will only work if you log in with administrative privileges.

<https://id.atlassian.com/manage-profile/security/api-tokens>

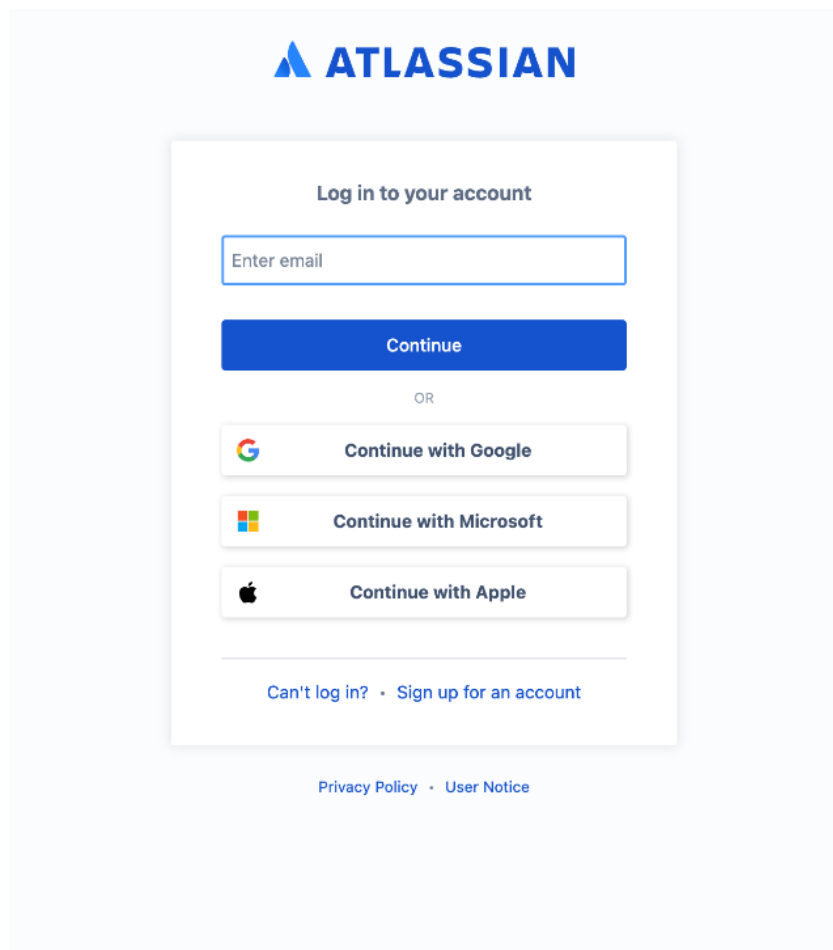

- Then navigate to **API tokens > Create API token**.

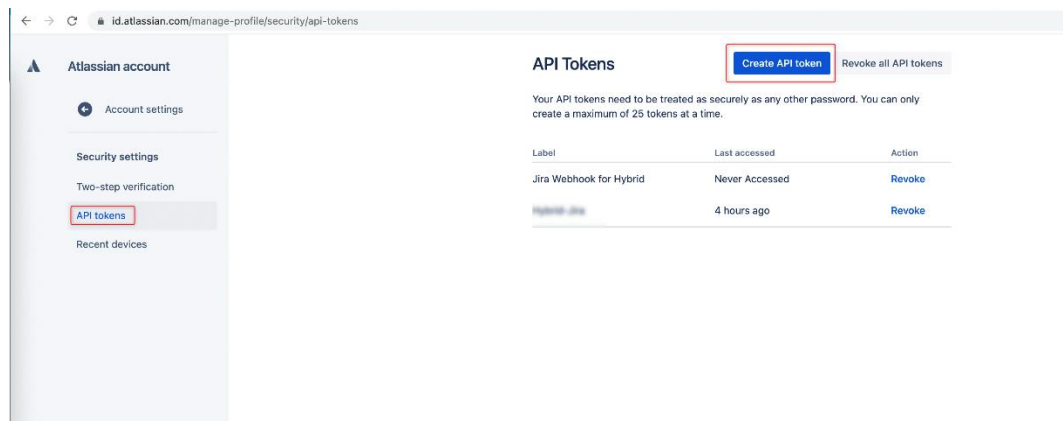

- In the popup window that appears, enter the Label. Because the token will be known by this name in the future, enter a label, that is easy to remember and Click **Create** button.

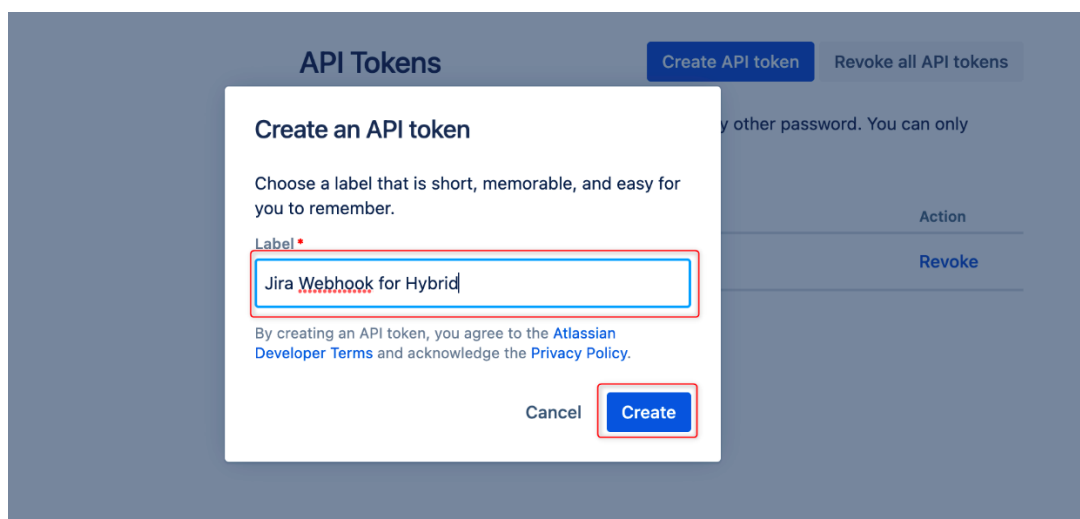

- The new API token will be created immediately. The token will only be displayed once so copy as soon as it is generated.

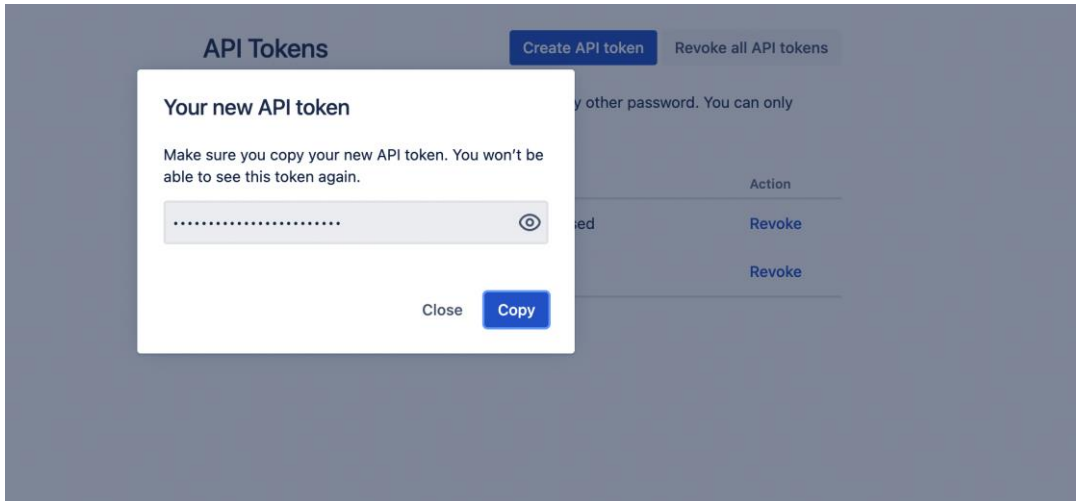

9. API token created successfully.

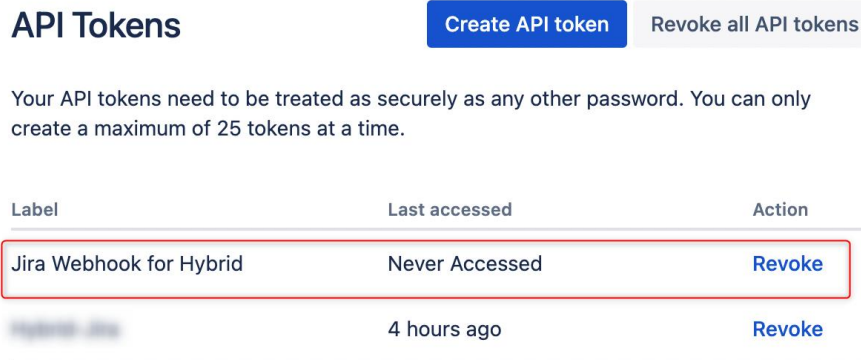

10. Once the token is created, the next step is to add it to the hybrid advanced settings. To do so, go to Hybrid **Advanced Settings**. Then paste the copied token into the **Application Token** column.

11. Also enter the **User ID** and **Base URL**.

User ID - The email id used to log in to the ATLASSIAN account can be entered as the User ID.

Base URL – Use the given URL as the Base URL <https://kloudspot.atlassian.net>

12. Click the **Save** button to save the changes.



To add JIRA in integrated Apps.

1. Navigate to **My Office > My Project** and Go to the **info page** of the project for which you want to add the JIRA.

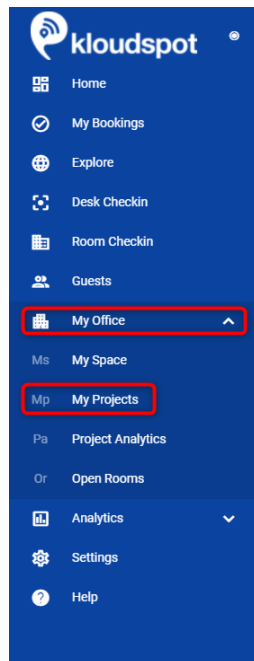

2. There are 2 ways to access the Project Info page.
 - a. Click on the **Menu button > Project info.**

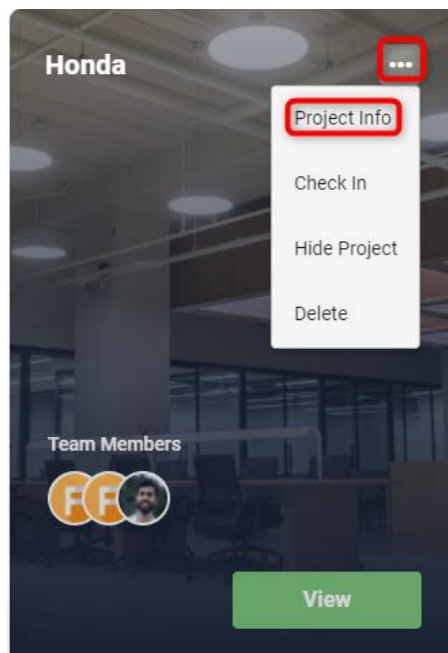

- b. Click **View > menu button > Project info.**

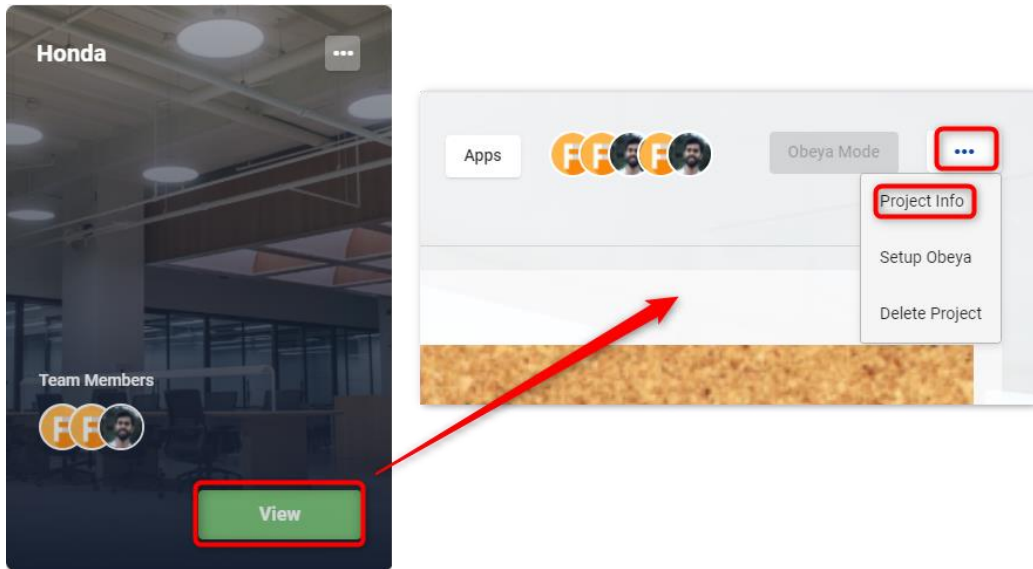

3. Click the **Save & continue** button until Project Apps appear.

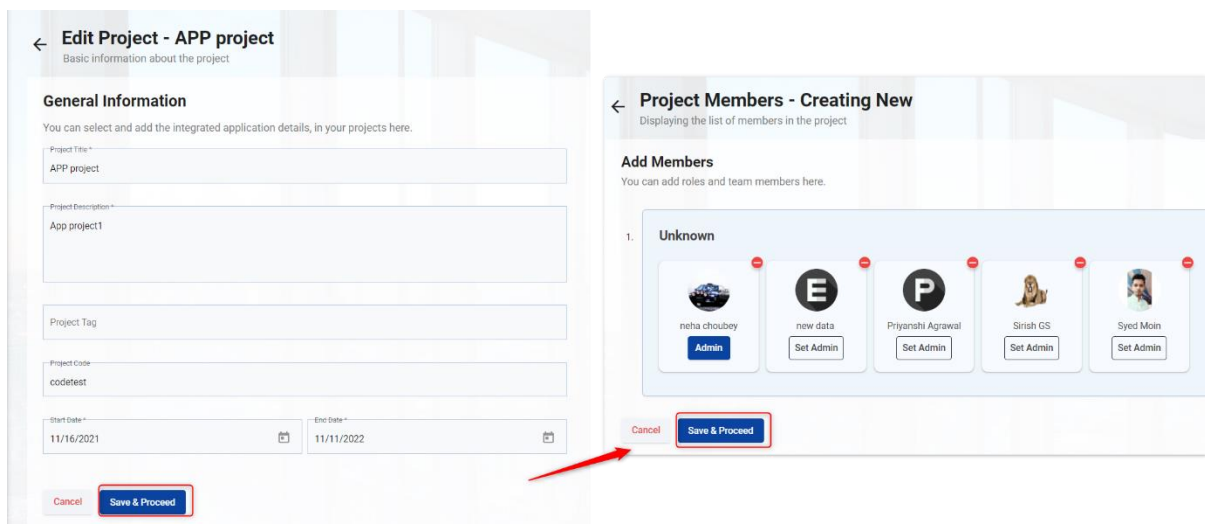

4. In the Project App window that opens, click the **Add** button in the Integrated Apps section.

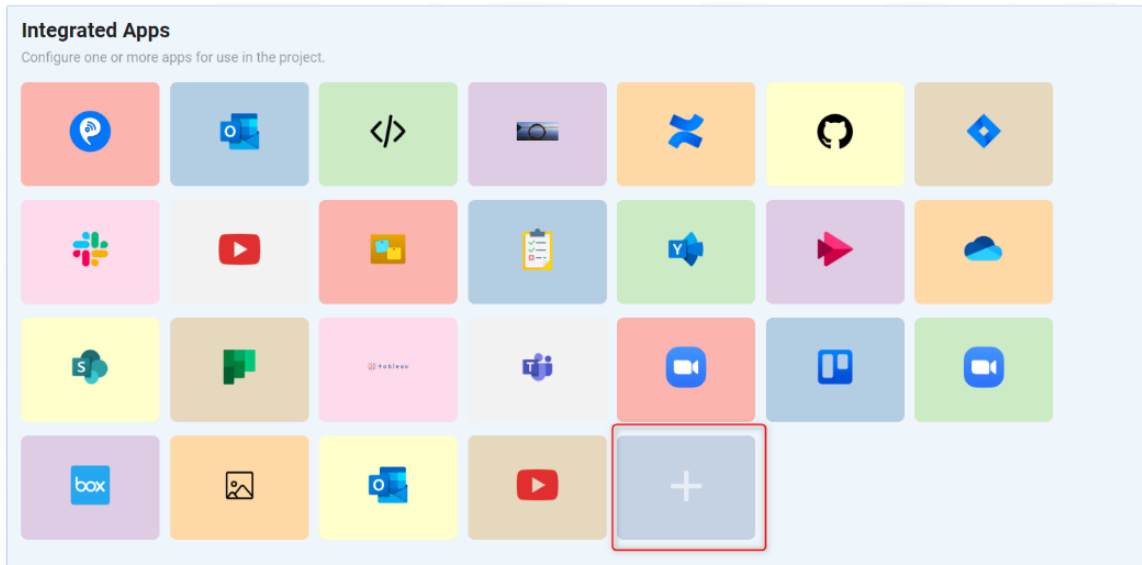

Done

5. Locate and click on the **JIRA** app, in the pop-up window that appears.

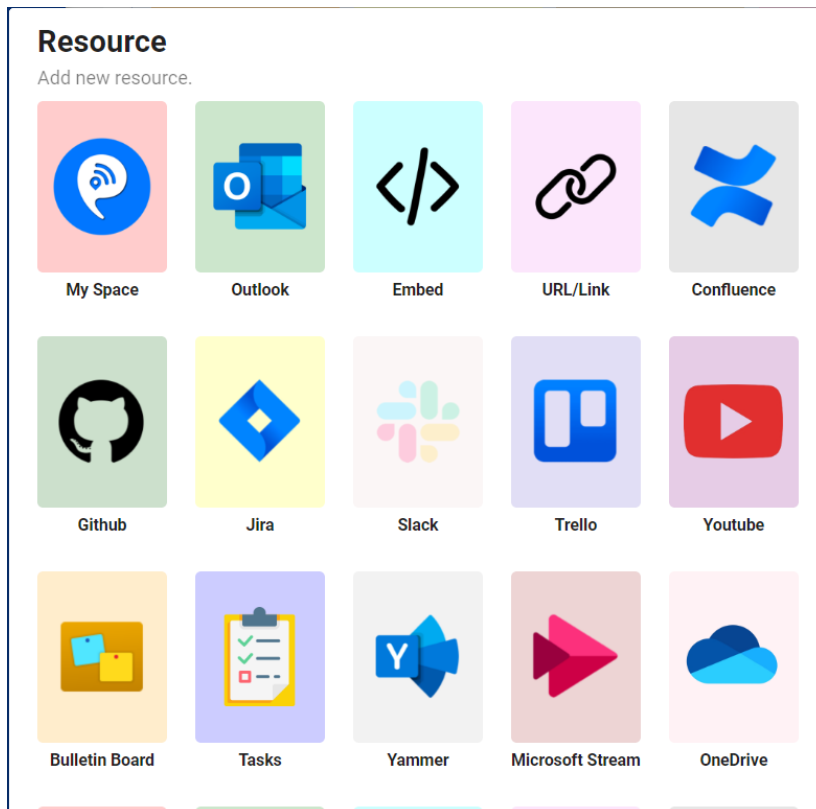

6. Copy the JIRA Repository URL and paste it into the URL section.
Note: When you click on the JIRA App Icon from the home page, this URL helps you determine which page to redirect.

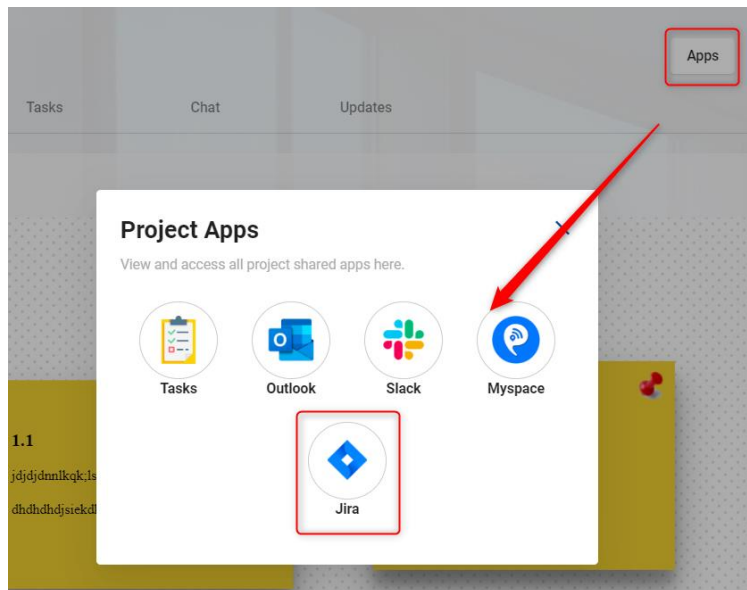

7. Check the **Enable Notifications** checkbox in the Resource window that opens.
8. Select the project name from the drop-down list and click **submit** button.
9. Updates to that project will be notified to project members.

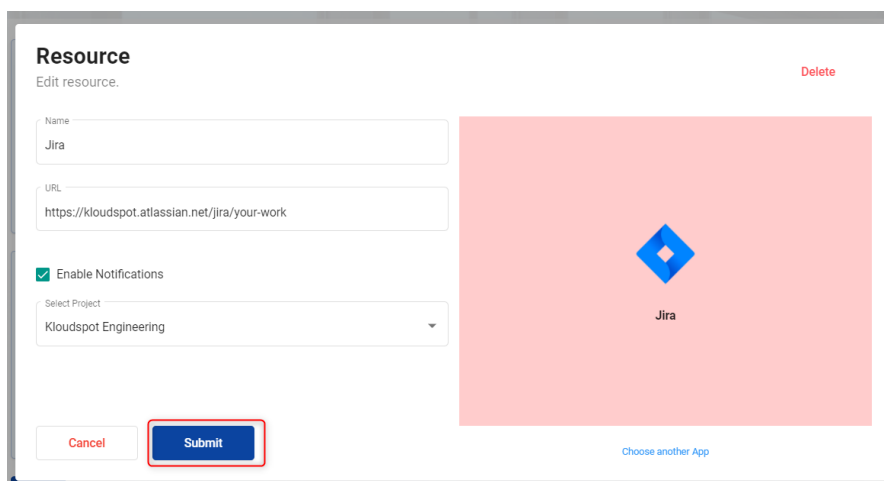

10. JIRA notification is enabled successfully.